



HORIZON AX RIC

User Guide

Made for
iPhone | iPad | iPod

Content

Welcome	4
Your hearing instruments	5
Instrument type	5
Getting to know your hearing instruments	6
Components and names	7
Controls	9
Hearing programs	10
Features	10
Batteries	11
Battery size and handling tips	11
Replacing batteries	12
Daily use	14
Turning on and off	14
Inserting and removing the hearing instruments	16
Adjusting the volume	21
Changing the hearing program	22
Further adjustments (optional)	22
Special listening situations	23
On the phone	23
Audio streaming with iPhone	23
Audio streaming with Android phone	24
Bluetooth	24

Maintenance and care	25
Hearing instruments	25
Ear pieces	26
Professional maintenance	28
Further information	29
Safety information	29
Accessories	29
Troubleshooting	31
Country-specific information	32
Service and warranty	35

Welcome

Thank you for choosing our hearing instruments to accompany you through everyday life. Like anything new, it may take you a little time to become familiar with them.

This guide, along with support from your Hearing Care Professional, will help you understand the advantages and greater quality of life your hearing instruments offer.

To receive the most benefit from your hearing instruments, it is recommended that you wear them every day, all day. This will help you get adjusted to them.



CAUTION

It is important to read this user guide and the safety manual thoroughly and completely. Follow the safety information to avoid damage or injury.



The device may not look exactly like the guiding illustrations in these instructions. We reserve the right to make any changes we consider necessary.

Your hearing instruments

i This user guide describes optional features that your hearing instruments may or may not have. Ask your Hearing Care Professional to indicate the features that are valid for your hearing instruments.

Instrument type

Your hearing instruments are a RIC (Receiver-in-Canal) model. The receiver is placed within the ear canal and connected to the instrument via a receiver cable. The instruments are not intended for children under the age of 3 years or persons with a developmental age of under 3 years.

The wireless functionality enables advanced audiological features and synchronization between your two hearing instruments.

Your hearing instruments feature Bluetooth® Low Energy* technology allowing for easy data exchange with your smartphone, and for seamless audio streaming with your iPhone** and for some Android smartphones that support Audio Streaming for Hearing Aids (ASHA).

* The Bluetooth word mark and logos are owned by the Bluetooth SIG, Inc., and any use of such marks by WS Audiology Denmark A/S of this product is under licenses. Other trademarks and trade names are those of their respective owners.

** iPad, iPhone, and iPod touch are trademarks of Apple Inc., registered in the U.S. and other countries.



Getting to know your hearing instruments

It is recommended to familiarize yourself with your new hearing instruments. With the instruments in your hand try using the controls and note their location on the instrument. This will make it easier for you to feel and press the controls while wearing the hearing instruments.



If you have problems pressing the controls of your hearing instruments while wearing them, you can use a remote control to control your instruments. With a dedicated smartphone app you have even more control options.



Components and names

This user guide describes several types of hearing instruments. Use the following pictures to identify the type of hearing instrument that you use.

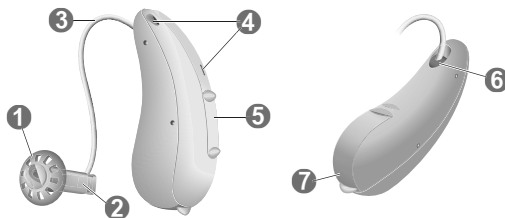

-
- | | |
|---------------------------|--|
| ❶ Ear piece | ❷ Battery compartment
(on/off switch) |
| ❸ Receiver | ❸ Side indicator
(red = right ear,
blue = left ear)
and receiver connection |
| ❹ Receiver cable | |
| ❺ Microphone openings | |
| ❻ Rocker switch (control) | |
-

You can use the following standard ear pieces:

Standard ear pieces	Size
<input type="radio"/> 	Sleeve 3.0, Vented, Closed, Power
<input type="radio"/> 	Eartip 3.0 Open
<input type="radio"/> 	Eartip 3.0 Tulip

You can easily exchange the standard ear pieces. Read more in section "Maintenance and care".

Custom-made ear pieces

<input type="radio"/> 	Earmold 3.0
---	-------------

Controls

With the rocker switch you can, for example, adjust the volume or switch hearing programs. Your Hearing Care Professional has programmed your desired functions to the rocker switch.



Rocker switch function	L	R
Press briefly:		
Program up/down	<input type="radio"/>	<input type="radio"/>
Volume up/down	<input type="radio"/>	<input type="radio"/>
Tinnitus therapy signal level up/down	<input type="radio"/>	<input type="radio"/>
TV stream on/off	<input type="radio"/>	<input type="radio"/>
Press for about 2 seconds:		
Program up/down	<input type="radio"/>	<input type="radio"/>
Volume up/down	<input type="radio"/>	<input type="radio"/>
Tinnitus therapy signal level up/down	<input type="radio"/>	<input type="radio"/>
TV stream on/off	<input type="radio"/>	<input type="radio"/>
Press for more than 3 seconds:		
Standby/turn on	<input type="radio"/>	<input type="radio"/>

L = Left, R = Right



You can also use a remote control to change hearing programs and adjust the volume of your hearing instruments. With our smartphone app you have even more control options.

Hearing programs

1

2

3

4

5

6

Read more in section "Changing the hearing program".

Features

- Power-on delay** enables whistle-free insertion of hearing instruments.
Read more in section "Turning on and off".
- The **tinnitus therapy feature** generates a sound to distract you from your tinnitus.

Batteries

When the battery is low the sound becomes weaker or you will hear an alert signal. The battery type will determine how long you have to replace the battery.

Battery size and handling tips

Ask your Hearing Care Professional for recommended batteries.

Battery size:	312
---------------	-----

- Always use the correct battery size for your hearing instruments.
- Remove the batteries if you intend not to use the hearing instruments for several days.
- Always carry spare batteries.
- Remove empty batteries immediately and follow your local recycling rules for battery disposal.

Replacing batteries

Removing the battery:

- ▶ Open the battery compartment.

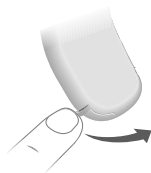

- ▶ Use the magnet stick to pull out the battery. The magnet stick is available as an accessory.

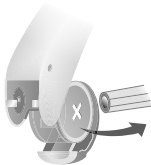

Inserting the battery:



- ▶ If the battery has a protective film, remove it only when you are ready to use the battery.



- ▶ Insert the battery with the "+" symbol facing up into the battery door (refer to the picture).



Note: Please do not place the battery directly into the housing.

- 
- 
- 
- ▶ Carefully close the battery compartment. If you feel resistance, the battery is not inserted correctly.

Do not attempt to close the battery compartment by force. It can be damaged.

Daily use

To assure comfortable and easy use of your hearing instruments they are equipped with an onboard control element. In addition we offer an app for Android as well as iPhones which makes handling your devices even easier. Contact your Hearing Care Professional for downloading and installing the smartphone app.

Turning on and off

You can turn your hearing instruments on or off via the battery compartment:

- ▶ Turning on: Close the battery compartment.
The **default** volume and hearing program are set.
- ▶ Turning off: Open the battery compartment to the first catch.

When wearing the hearing instruments, an alert tone can indicate when an instrument is being turned on or off.

When the **power-on delay** is activated, the hearing instruments turn on after a delay of several seconds. During this time you can insert the hearing instruments into your ears without experiencing unpleasant feedback whistling.

The "power-on delay" can be activated by your Hearing Care Professional.



Switching to standby mode

You have following options to switch your device into standby mode:

- via remote control
- via rocker switch.

Turning on or off:

Press and hold the rocker switch for several seconds.

Refer to section "Controls" for the settings of the rocker switch.

Standby mode mutes the device. When you leave standby mode, the **previously** used volume and hearing program are set.

Note:

- In standby mode, the device is not turned off completely. It draws some power. Therefore, we recommend to use standby mode only for a short period of time.
- If you want to leave standby mode, but the remote control is not at hand, turn your device off and on again (by opening and closing the battery compartment). In this case, the **default** volume and hearing program are set.





Inserting and removing the hearing instruments

Your hearing instruments have been fine-tuned for your right and left ear. Colored markers indicate the side:

- red marker = right ear
- blue marker = left ear



Inserting a hearing instrument:

- For Sleeves, take care that the bend of the Sleeve is in line with the bend of the receiver cable.

See illustrations on next page.

Correct:

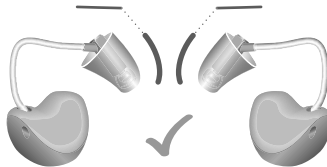

Incorrect:

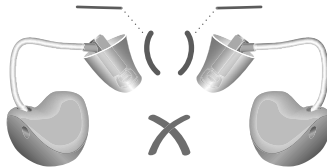

- ▶ Hold the receiver cable at the bend closer to the ear piece.
- ▶ Carefully push the ear piece in the ear canal ❶.
- ▶ Twist it slightly until it sits well.

Open and close your mouth to avoid accumulation of air in the ear canal.

- ▶ Lift the hearing instrument and slide it over the top of your ear ❷.

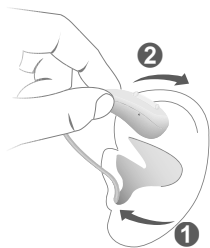

CAUTION

Risk of injury!

- ▶ Always wear the receiver cable with an ear piece.
- ▶ Make sure that the ear piece is completely attached.



CAUTION

Risk of injury!

- ▶ Insert the ear piece carefully and not too deeply into the ear.

i

- It may be helpful to insert the **right** hearing instrument with the **right** hand and the **left** hearing instrument with the **left** hand.
- If you have problems inserting the ear piece, use the other hand to gently pull your earlobe downwards. This opens the ear canal and eases insertion of the ear piece.

The optional retention strand helps to securely retain the ear piece in your ear. To attach the optional retention strand:

- ▶ Align the end of the retention strand with the flat end of the receiver.

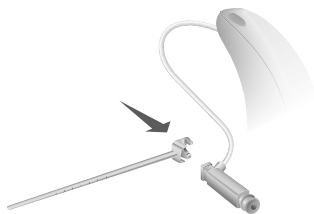

- ▶ Then press the retention strand towards the receiver until it clicks into place.



To position the retention strand:

- ▶ Bend the retention strand and position it carefully into the bottom of the bowl of your ear (refer to the picture).



Removing a hearing instrument:

- ▶ Lift the hearing instrument and slide it over the top of your ear ①.
- ▶ If your hearing instrument is equipped with a custom shell or a mold, remove it by pulling the small removal cord toward the back of your head.
- ▶ For all other ear pieces: Grip the receiver in the ear canal with two fingers and pull it carefully out ②.

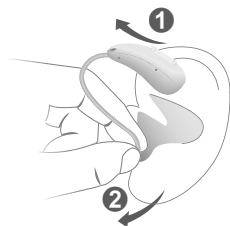

Do not pull the receiver cable.



CAUTION

Risk of injury!

- ▶ In very rare cases the ear piece could remain in your ear when removing the hearing instrument. If this happens, have the ear piece removed by a medical professional.

Clean and dry your hearing instruments after usage.
Read more in section "Maintenance and care".



Adjusting the volume

Your hearing instruments automatically adjust the volume to the listening situation.

- ▶ If you prefer manual volume adjustment, press the rocker switch.

Refer to section "Controls" for the setting of the rocker switch.

An optional signal tone can indicate the volume change. Once the maximum or minimum volume has been reached, you may hear an optional signal tone.





Changing the hearing program

Depending on the listening situation, your hearing instruments automatically adjust their sound.

Your hearing instruments may also have several hearing programs which allow you to change the sound, if needed. An optional signal tone can indicate the program change.

- ▶ To change the hearing program, press the rocker switch.

Refer to section "Controls" for the setting of the rocker switch. Refer to section "Hearing programs" for a list of your hearing programs.

The default volume is applied.



Further adjustments (optional)

You can also use the hearing instrument controls to change other features, for example, the level of the tinnitus therapy signal.

Refer to section "Controls" for the setting of your controls.



Special listening situations

On the phone

When you are on the phone, hold the telephone receiver slightly above your ear. The hearing instrument and telephone receiver have to be aligned. Turn the receiver slightly so that the ear is not completely covered.



Telephone program

You may prefer a certain volume when using the phone. Ask your Hearing Care Professional to configure a telephone program.

- ▶ Switch to the telephone program whenever you are on the phone.

If a telephone program is configured for your hearing instruments, it is listed in section "Hearing programs".

Audio streaming with iPhone

Your hearing instruments are Made for iPhone hearing instruments. This means you can get phone calls and listen to music from your iPhone directly into your hearing instruments.

For more information about compatible iOS devices, pairing, audio streaming and other useful functions, contact your Hearing Care Professional.



Audio streaming with Android phone

If your mobile phone supports Audio Streaming for Hearing Aids (ASHA), you can get phone calls and listen to music from your mobile phone directly into your hearing instruments.

For more information about compatible Android devices, pairing, audio streaming and other useful functions, contact your Hearing Care Professional.

Bluetooth

Your device is equipped with Bluetooth®* wireless technology to enable audio streaming from mobile phones or other compatible devices.

In an airplane, the use of Bluetooth functionality may be restricted, especially during take-off and landing. If this is the case, you can switch off Bluetooth wireless technology in your device via the smartphone app.

* The Bluetooth word mark and logos are owned by the Bluetooth SIG, Inc., and any use of such marks by WS Audiology Denmark A/S of this product is under licenses. Other trademarks and trade names are those of their respective owners.



Maintenance and care

To prevent damage it is important that you take care of your hearing instruments and follow a few basic rules, which will soon become a part of your daily routine.

Hearing instruments

Drying and storage

- ▶ Dry your hearing instruments overnight.
- ▶ For longer periods of non-use, store your hearing instruments in a dry environment with an open battery compartment and the batteries removed.
- ▶ Ask your Hearing Care Professional for more information.

Cleaning

Your hearing instruments have a protective coating. However, if not cleaned regularly you may damage the hearing instruments or cause personal injury.

- ▶ Clean your hearing instruments daily with a soft, dry tissue.
- ▶ Never use running water or immerse the devices in water.
- ▶ Never apply pressure while cleaning.
- ▶ Ask your Hearing Care Professional for recommended cleaning products, special care sets, or more information on how to keep your hearing instruments in good condition.



Ear pieces

Cleaning

Cerumen (ear wax) may accumulate on the ear pieces. This may affect sound quality. Clean the ear pieces daily.

For all types of ear pieces:

- ▶ Clean the ear piece right after removal with a soft and dry tissue.

This prevents that cerumen becomes dry and hard.

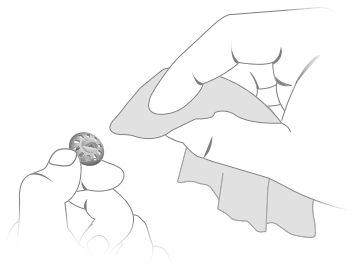

Exchanging

Exchange standard ear pieces approximately every three months. Replace them sooner if you notice cracks or other changes. The procedure for exchanging standard ear pieces depends on the type of ear piece. In section "Components and names", your Hearing Care Professional has marked your type of ear piece.

- ▶ To remove the old Eartip or Sleeve, follow the illustration below. Be careful not to pull the receiver cable.

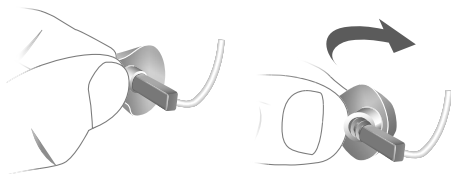

- ▶ Take particular care that the new Eartip or Sleeve covers the retention rings of the receiver fully.
- ▶ Check the firm fit of the new Eartip or Sleeve.

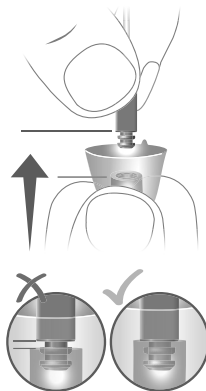



Professional maintenance

Your Hearing Care Professional can perform a thorough professional cleaning and maintenance.

Custom-made ear pieces and wax filters should be exchanged as needed by your Hearing Care Professional.

Ask your Hearing Care Professional for your individual recommendation of maintenance intervals and for support.





Further information

Safety information

For more safety information, refer to the safety manual supplied with the device.

Accessories

You can use the smartphone app for convenient remote control of your hearing instruments. The app also allows you to deactivate signal tones, to create individual sound profiles and many more functions.

You can also use a remote control.

Consult your Hearing Care Professional for further information.



Explanation of symbols

Symbols used in our documents



Points out a situation that could lead to serious, moderate, or minor injuries.



Indicates possible property damage.



Advice and tips on how to handle your device better.



CE compliance label, confirms compliance with certain European Directives, refer to section "Conformance information".



Indicates the legal manufacturer of the device.

Made for



iPhone | iPad | iPod

"Made for iPhone", "Made for iPad", and "Made for iPod" mean that an electronic accessory has been designed to connect specifically to iPhone, iPad, or iPod, respectively, and has been certified by the developer to meet Apple performance standards. Apple is not responsible for the operation of this device or its compliance with safety and regulatory standards. Please note that the use of this accessory with iPhone, iPad, or iPod may affect wireless performance.

Troubleshooting

Problem and possible solutions

Sound is weak.

- Increase the volume.
 - Replace the empty battery.
 - Clean or exchange the ear piece.
-

Hearing instrument emits whistling sounds.

- Reinsert the ear piece until it fits securely.
 - Decrease the volume.
 - Clean or exchange the ear piece.
-

Sound is distorted.

- Decrease the volume.
 - Replace the empty battery.
 - Clean or exchange the ear piece.
-

Hearing instrument emits signal tones.

- Replace the empty battery.
-

Hearing instrument does not work.

- Turn the hearing instrument on.
 - Gently close the battery compartment completely.
 - Replace the empty battery.
 - Make sure the battery is inserted correctly.
 - Power-on delay is active. Wait several seconds and check again.
-

Consult your Hearing Care Professional if you encounter further problems.

Country-specific information

USA and Canada

Certification information for hearing instruments with wireless functionality:

HORIZON RIC AX

- HVIN: RFM003
- Contains FCC ID: 2AXDT-RFM003
- Contains IC: 26428-RFM003

Service and warranty

Serial numbers	Instrument	Receiver unit
----------------	------------	---------------

Left:

Right:

Service dates

1:

4:

2:

5:

3:

6:

Warranty

Date of purchase:

Warranty period in months:

Your Hearing Care Professional

**Manufactured for
Distributor**

hear.com LLC
396 Alhambra Circle, S-700
Miami, Florida 33134
USA

 **Legal Manufacturer**

WSAUD A/S
Nymøllevej 6
3540 Lyngø
Denmark

Information in this brochure is subject to
change without notice.

Hearing Instrument Made in Singapore.

Document No. 04864-99T01-7600 EN
Order/Item No. 21023043 Rev. 1.0 D21023043
Master Rev01, 06.2022 SIV-14080-22
© 06.2022, WSAUD A/S. All rights reserved



21023043

www.hear.com